

# Torcflex

## Premium Square Drive Range



Scan me to view the webpage!

### The new Torcflex Hydraulic Torque wrench, the torque wrench you didn't know you needed.

The new Torcflex Torque Wrench line brings innovation to the hydraulic torque market, with increased safety at the heart of everything.

New features include: The **co-axial coupling**; this will drastically reduce set-up time and increase safety, a **retained reaction arm**; this will stop the drop hazard, and ensure the reaction arm stays on the tool, an **integral square drive**; which will prevent drop hazards and accidental loss of components and a **new adjustable support handle**; this is offered as standard with every wrench.



# TF Series

## Square drive hydraulic torque wrench

Atlas Copco TF Series of hydraulic wrench, offers high torque output, reliability and increased efficiency.



### Monobloc aluminium housing

High strength, lightweight housing: Designed to give superior rigidity and strength resulting in excellent torque to weight ratio and durability. Housing has multiple docking points for support handle.

### Co-Axial Hose and Coupling

The launch of the Co-Axial coupling and hose system is an innovative solution to increase productivity and reduce fatigue of the operator. Optional traditional twin swivel version available.

### Retained Reaction Arm

Prevents drop hazard and provides right first time reaction arm positioning.

### Reaction Pawl

Reduces operator intervention and increases tightening speed.

### Ergonomic Support Handle

Multiple attachment points and quick rotational adjustment improves operator safety.

### High strength steel boot

The reaction arm integral hazard warning stripes comes as standard.

### Square Drive with Integrated Retainer

Single piece, quick change square drive prevents drop hazards and accidental loss of separate retainer.

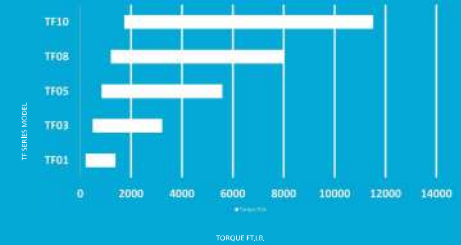

### Square Drive Sizes

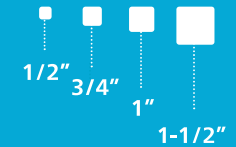

## TF Series technical information



Model	Square Drive in	Torque				Weight		Ordering No Co-axial/Twin
		min	max	min	max	lb	kg	
TF01	3/4	209	1390	283	1885	6,06 / 6,44	2,75 / 2,92	8434 2406 05 / 8434 2410 15
TF03	1	485	3230	657	4379	12,06 / 12,43	5,47 / 5,64	8434 2409 95 / 8434 2409 94
TF05	1-1/2	839	5590	1137	7579	20,3 / 20,68	9,21 / 9,38	8434 2411 16 / 8434 2411 17
TF08	1-1/2	1200	8000	1627	10847	27,23 / 27,26	12,35 / 12,52	8434 2411 49 / 8434 2411 50
TF10	1-1/2	1728	11520	2343	15619	34,99 / 35,36	15,87 / 16,04	8434 2415 24 / 8434 2415 25

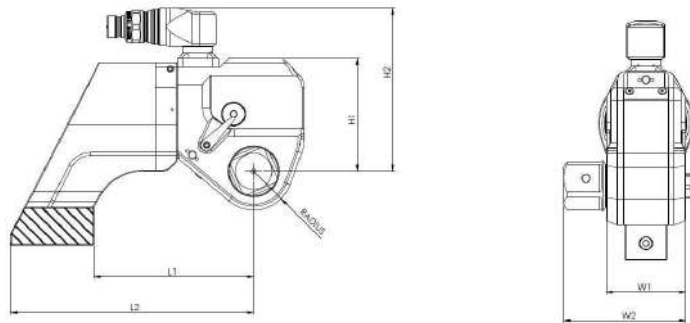

Model	Dimensions													
	L1		L2		H1		H2*		Radius		W1		W2	
	in	mm	in	mm	in	mm	in	mm	in	mm	in	mm	in	mm
TF01	3,98	101	6,18	157	3,03	77	4,97 / 4,79	126 / 122	0,97	24,7	1,97	50	2,87	73
TF03	4,96	126	8,03	204	3,82	97	5,82 / 5,64	148 / 143	1,29	32,8	2,64	67	3,7	94
TF05	6,34	161	9,69	246	4,51	114,5	6,51 / 6,32	165 / 161	1,54	39,1	3,15	80	4,84	123
TF08	6,73	171	10,91	277	4,96	126,1	6,97 / 6,78	177 / 172	1,76	44,6	3,58	91	5,12	130
TF10	8,19	208	12,32	313	5,87	149	7,87 / 7,68	200 / 195	3,76	95,6	3,94	100	5,51	140

Designs and specifications are subject to change without notice or obligation. Read all safety instructions in the manual before usage.

\*Values separated by slash are for model variants: Co-axial / Twin

## TF Series standard setup

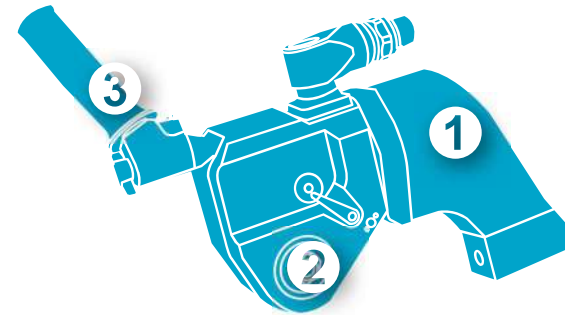

All TF wrenches are provided with the following equipment as standard:

1. Adjustable Retained Reaction Arm.
2. Square Drive with Integrated Retainer for use with impact sockets.
3. Fully Adjustable Ergonomic Support Handle.
4. Peli-case style packaging and custom foam.
5. All TF wrenches can be supplied with Co-Axial coupling or standard twinline.

### Use high quality impact sockets

Hydraulic wrenches in TF Series offer extremely high torque output. Excellent power to weight ratio and range of 5 models covering torque from 283 – 15619 Nm (209 - 11520 Ft. lb.).

## TF & RT Series accessories



These are available in various sizes. Please contact our sales team for more information.

Ordering No	Size	Description
8434 2101 72	1/2"	RT0.5-HX-008
8434 2138 44	10mm	RT0.5-HX-10MM
8434 2138 47	12mm	RT0.5-HX-12MM
8434 2138 50	14mm	RT0.5-HX-14MM
8434 2138 53	16mm	RT0.5-HX-16MM
8434 2138 56	17mm	RT0.5-HX-17MM
8434 2138 59	18mm	RT0.5-HX-18MM
8434 2138 62	19mm	RT0.5-HX-19MM
8434 2138 65	20mm	RT0.5-HX-20MM
8434 2138 68	22mm	RT0.5-HX-22MM
8434 2101 71	24mm	RT0.5-HX-24MM
8434 2138 71	5/8"	RT01-HX-010
8434 2138 74	3/4"	RT01-HX-012
8434 2138 77	7/8"	RT01-HX-014
8434 2056 94	1"	RT01-HX-100
8434 2138 83	10mm	RT01-HX-10MM
8434 2138 86	14mm	RT01-HX-14MM
8434 2138 89	16mm	RT01-HX-16MM
8434 2056 96	17mm	RT01-HX-17MM
8434 2138 92	18mm	RT01-HX-18MM
8434 2056 98	19mm	RT01-HX-19MM
8434 2057 00	20mm	RT01-HX-20MM
8434 2057 02	22mm	RT01-HX-22MM
8434 2057 04	24mm	RT01-HX-24MM
8434 2138 98	25mm	RT01-HX-25MM
8434 2138 95	26mm	RT01-HX-26MM
8434 2057 06	27mm	RT01-HX-27MM
8434 2057 14	5/8"	RT03-HX-010
8434 2057 16	3/4"	RT03-HX-012
8434 2057 18	7/8"	RT03-HX-014
8434 2057 20	1"	RT03-HX-100
8434 2139 28	1 1/8"	RT03-HX-102
8434 2139 31	1 1/4"	RT03-HX-104
8434 2139 34	1 1/2"	RT03-HX-108
8434 2139 35	15mm	RT03-HX-15MM
8434 2139 36	16mm	RT03-HX-16MM
8434 2139 37	17mm	RT03-HX-17MM
8434 2057 22	19mm	RT03-HX-19MM
8434 2057 24	22mm	RT03-HX-22MM
8434 2057 26	24mm	RT03-HX-24MM
8434 2139 43	26mm	RT03-HX-26MM
8434 2057 28	27mm	RT03-HX-27MM
8434 2139 46	30mm	RT03-HX-30MM
8434 2057 30	32mm	RT03-HX-32MM
8434 2139 49	36mm	RT03-HX-36MM

Ordering No	Size	Description
8434 2139 55	38mm	RT03-HX-38MM
8434 2139 58	41mm	RT03-HX-41MM
8434 2139 61	46mm	RT03-HX-46MM
8434 2139 64	55mm	RT03-HX-55MM
8434 2140 04	1"	RT-05
8434 2140 13	1 1/4"	RT05-HX-104
8434 2139 97	19mm	RT05-HX-19MM
8434 2140 00	22mm	RT05-HX-22MM
8434 2140 03	24mm	RT05-HX-24MM
8434 2140 06	26mm	RT05-HX-26MM
8434 2057 36	27mm	RT05-HX-27MM
8434 2140 10	30mm	RT05-HX-30MM
8434 2140 12	32mm	RT05-HX-32MM
8434 2057 38	36mm	RT05-HX-36MM
8434 2057 39	38mm	RT05-HX-38
8434 2057 40	41mm	RT05-HX-41MM
8434 2057 42	46mm	RT05-HX-46MM
8434 2140 20	50mm	RT05-HX-50MM
8434 2140 21	55mm	RT05-HX-55MM
8434 2140 45	24mm	RT08-HX-24MM
8434 2140 48	27mm	RT08-HX-27MM
8434 2140 69	1"	RT10-HX-100
8434 2140 72	1 1/2"	RT10-HX-108
8434 2140 75	32mm	RT10-HX-32MM
8434 2057 46	36mm	RT10-HX-36MM
8434 2057 48	41mm	RT10-HX-41MM
8434 2057 50	46mm	RT10-HX-46MM
8434 2057 52	50mm	RT10-HX-50MM
8434 2140 81	55mm	RT10-HX-55MM

## Hex drive dimensions

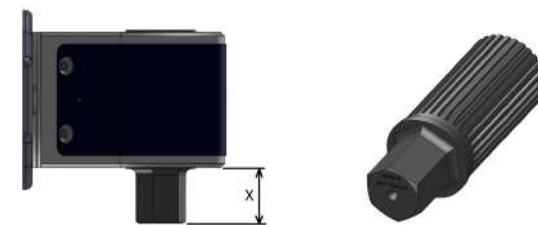

### RT Hex Drives - Inch Series

Wrench Ref	Hex AF inch	X inch	Max Torque lbf.ft
RT-0.5	3/8	0.472	149
RT-0.5	7/16	0.512	236
RT-0.5	1/2	0.551	353
RT-0.5	5/8	0.591	689
RT-01	5/8	0.709	689
RT-01	3/4	0.827	1191
RT-01	7/8	0.945	1892
RT-01	1	1.063	2824
RT-03	3/4	0.906	1191
RT-03	7/8	1.024	1892
RT-03	1	1.142	2824
RT-03	1 1/4	1.299	5516
RT-05	1	1.142	2824
RT-05	1 1/4	1.299	5516
RT-05	1 1/2	1.417	9531
RT-05	1 3/4	1.614	15135
RT-08	1	1.142	2824
RT-08	1 1/4	1.299	5516
RT-08	1 1/2	1.417	9531
RT-08	1 3/4	1.614	15135
RT-10	1 1/4	1.339	5516
RT-10	1 1/2	1.457	9531
RT-10	1 3/4	1.654	15135
RT-10	2	1.850	22593

### RT Hex Drives - Metric Series

Wrench Ref	Hex AF mm	X mm	Max Torque Nm
RT-0.5	10	12	234
RT-0.5	12	13	404
RT-0.5	14	14.5	641
RT-0.5	17	16	1147
RT-01	17	19	1147
RT-01	19	21	1602
RT-01	22	24.5	2486
RT-01	27	28	4596
RT-03	19	23	1602
RT-03	22	26.5	2486
RT-03	27	30	4596
RT-03	32	35	7652
RT-05	27	30	4596
RT-05	32	35	7652
RT-05	36	39	10895
RT-05	41	45	16094
RT-08	27	30	4596
RT-08	32	35	7652
RT-08	36	39	10895
RT-08	41	45	16094
RT-10	32	36	7652
RT-10	36	40	10895
RT-10	41	46	16094
RT-10	46	50	22730
RT-10	50	52	29190

## Hex drives with retainer assembly



RT / TF Series	Retainer SAP No
RT01	4222212703
RT03	4222210294
RT05	4222210399
RT08	4222210504
RT10	4222210579

Retainer button to be purchased, if using with the TF too



# RT Series

## Square drive hydraulic torque wrench

Atlas Copco RT Series standard hydraulic wrenches offer extremely high torquing power. There are nine models to choose from.

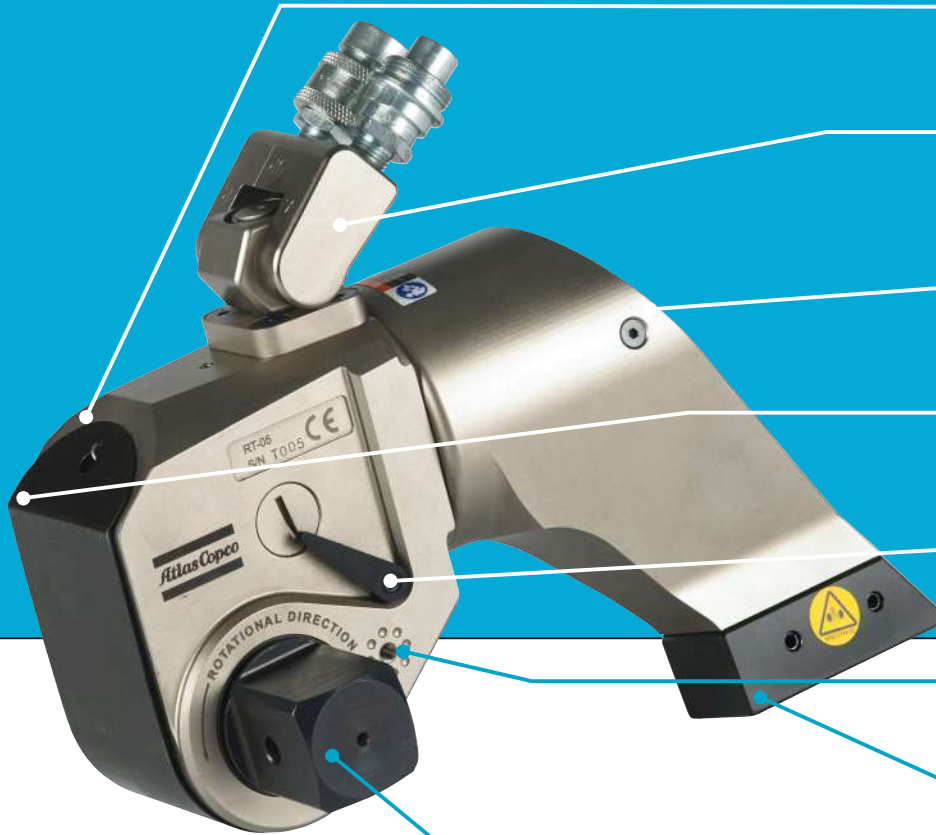

**Monobloc aluminium housing**  
A single block of aircraft quality aluminum alloy is used to produce the RT Series housing. This allows the tool to produce massive amounts of torque, while having an amazing power-to-weight ratio.

**Multi-axis swivel**  
Greater range of movement on multiple axis allows the hose to move easier compared to single axis swivels.

**Splined reaction arm**  
Splined reaction arm makes the tool more compact and allows the reaction arm to be adjusted for maximum safety.

**Spring-loaded shroud**  
Spring loaded shroud absorbs energy during operation.

**Safety pawl**  
Increases speed and reduces operator intervention.

**Tapped handle security point**

**High strength steel boot**  
The reaction arm boot comes standard. Copper boot also available.

**Splined square drive**  
The RT Series splined square drive distributes load evenly through the drive components, providing full heavy-duty transmission of force. Direct Hex Drives and Hex Adapters are available.

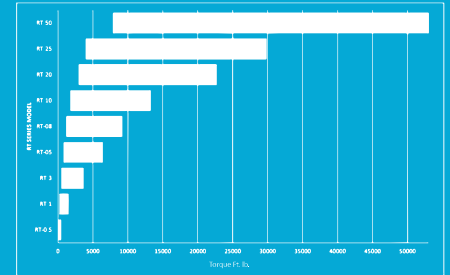

### Square Drive Sizes

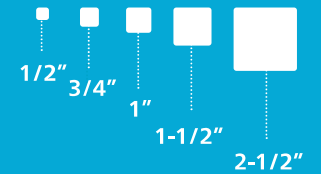

## RT Series technical information



Model	Square Drive in	Torque				Weight		Ordering No.
		ft. lb.		Nm		lb	kg	
		min	max	min	max			
RT-0,5	1/2	60	397	81	538	0,8	0,4	8434 2010 00
RT-01	3/4	209	1390	283	1885	3,8	1,9	8434 2010 02
RT-03	1	485	3230	657	4379	7,8	3,9	8434 2010 05
RT-05	1-1/2	839	5590	1137	7579	15	7,5	8434 2010 09
RT-08	1-1/2	1200	8000	1627	10846	23	11,5	8434 2010 13
RT-10	1-1/2	1728	11520	2343	15619	26,8	13,4	8434 2010 16
RT-20	2-1/2	2964	19760	4019	26791	36	18	8434 2010 20
RT-25	2-1/2	3884	25890	5266	35102	62	31	8434 2010 25
RT-50	2-1/2	7875	52500	10677	71180	96	48	8434 2010 29

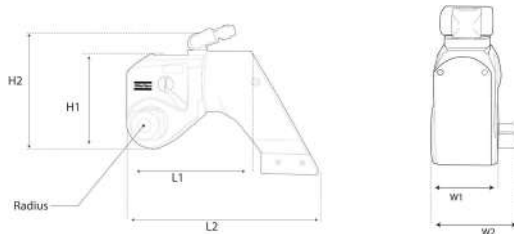

Model	Dimensions													
	L1		L2		H1		H2		Radius		W1		W2	
	in	mm	in	mm	in	mm	in	mm	in	mm	in	mm	in	mm
RT-0,5	3,15	81	4,87	125	2,35	60,5	3,62	93	0,52	13,5	1,3	33,5	1,97	50,5
RT-01	4,68	120	7,13	183	3,52	90,5	4,75	122	0,9	23	1,95	50	2,76	71
RT-03	6,04	155	9,24	237	4,68	120	6,08	156	1,28	33	2,59	66,5	3,72	95,5
RT-05	7,21	185	11,23	288	5,63	144,5	7,05	181	1,44	37	3,12	80	4,9	126
RT-08	7,85	202	12,49	321	6,42	164,6	8,4	213,36	1,62	41	3,48	88	4,95	126
RT-10	9	232	13,9	357	7,2	186	9,3	239	1,87	48	3,9	100	5,5	142,5
RT-20	10,2	259	16,55	420	8,5	216	9,9	251	2,17	55,1	4,7	119	6,7	170
RT-25	12	310	18,4	473	9,1	234	11	282	2,37	61	5,2	134	7,4	191
RT-50	15,2	390	23,9	615	11,4	294	13,4	344	30,8	79	6,5	167	8,9	228

## RT Series standard setup

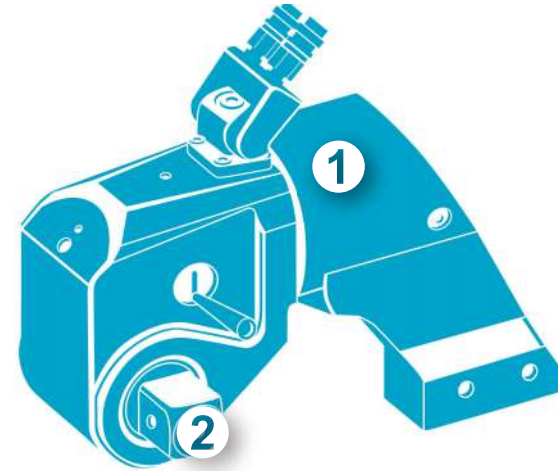

- 1 The RT comes with the standard reaction arm, great for many common applications.
- 2 The RT Series comes standard with a square drive, use with a socket.

### Use high quality impact sockets

Hydraulic wrenches in RT Series offer extremely high torquing power. Excellent power to weight ratio and range of 9 models covering torque from 81 – 71180 Nm (60 - 52500 Ft. lb.) makes it the most preferred wrench in the market.

# Square drive hydraulic torque wrench accessories

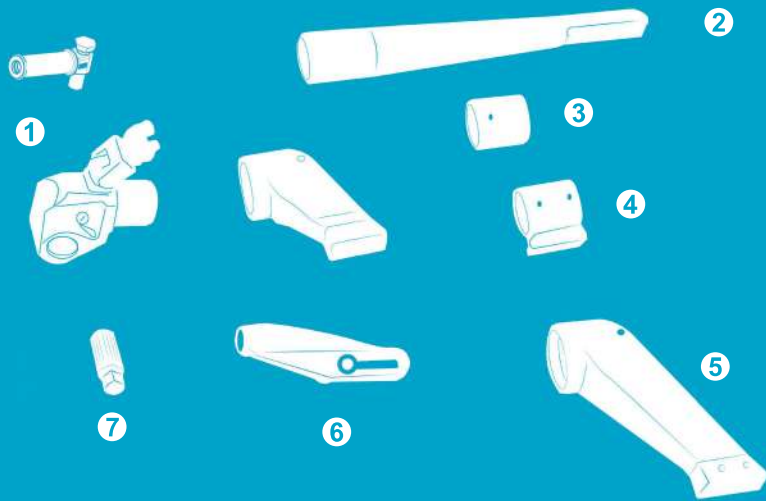

- 1** RT safety handle
- 2** Alco reaction arm
- 3** Steel sleeve
- 4** Steel sleeve with foot
- 5** Extended reaction arm
- 6** Sliding reaction arm
- 7** Direct hex drive

## 1 Support safety handle



Description	Ordering No.
Handle for RT3, RT5, RT8, RT10	8434 2170 31

## 2 Alco arm



Description	Ordering No.
RT0,5-ALC	4222 2126 76
RT01-ALC	4222 2102 64
RT03-ALC	8434 2057 10
RT05-ALC	8434 2139 88
RT08-ALC	8434 2140 36
RT10-ALC	8434 2140 60

## 3 Steel sleeve



Description	Ordering No.
RT0,5-SSLV	4222 2126 88
RT01-SSLV	8434 2057 08
RT03-SSLV	8434 2057 32
RT05-SSLV	8434 2140 30
RT08-SSLV	8434 2140 51
RT10-SSLV	8434 2140 90

## 4 Steel sleeve with foot



Description	Ordering No.
RT01-SSLVF	8434 2057 09
RT03-SSLVF	8434 2139 79
RT05-SSLVF	8434 2139 80

## 5 Ext arm



Description	Ordering No.
RT0,5-EXT	4222 2126 82
RT01-EXT	8434 2056 92
RT03-EXT	8434 2057 12
RT05-EXT	8434 2057 34
RT08-EXT	8434 2140 42
RT10-EXT	8434 2140 66

## 6 Sliding reaction arm



Description	Ordering No.
RT-01 Sliding Ext	8434 2057 33
RT-01 Sliding Std	8434 2150 95
RT-03 Sliding Ext	8434 2150 37
RT-03 Sliding Std	8434 2150 30
RT-05 Sliding Ext	8434 2150 36
RT-05 Sliding Std	8434 2150 35
RT-08 Sliding Ext	8434 2150 32
RT-08 Sliding Std	8434 2150 31
RT-10 Sliding Ext	8434 2150 34
RT-10 Sliding Std	8434 2150 33

STD= Standard      EXT=Extended